

PATH LENGTHS & SLOPES

PAGE 1

① CHECK FOR A SCALE

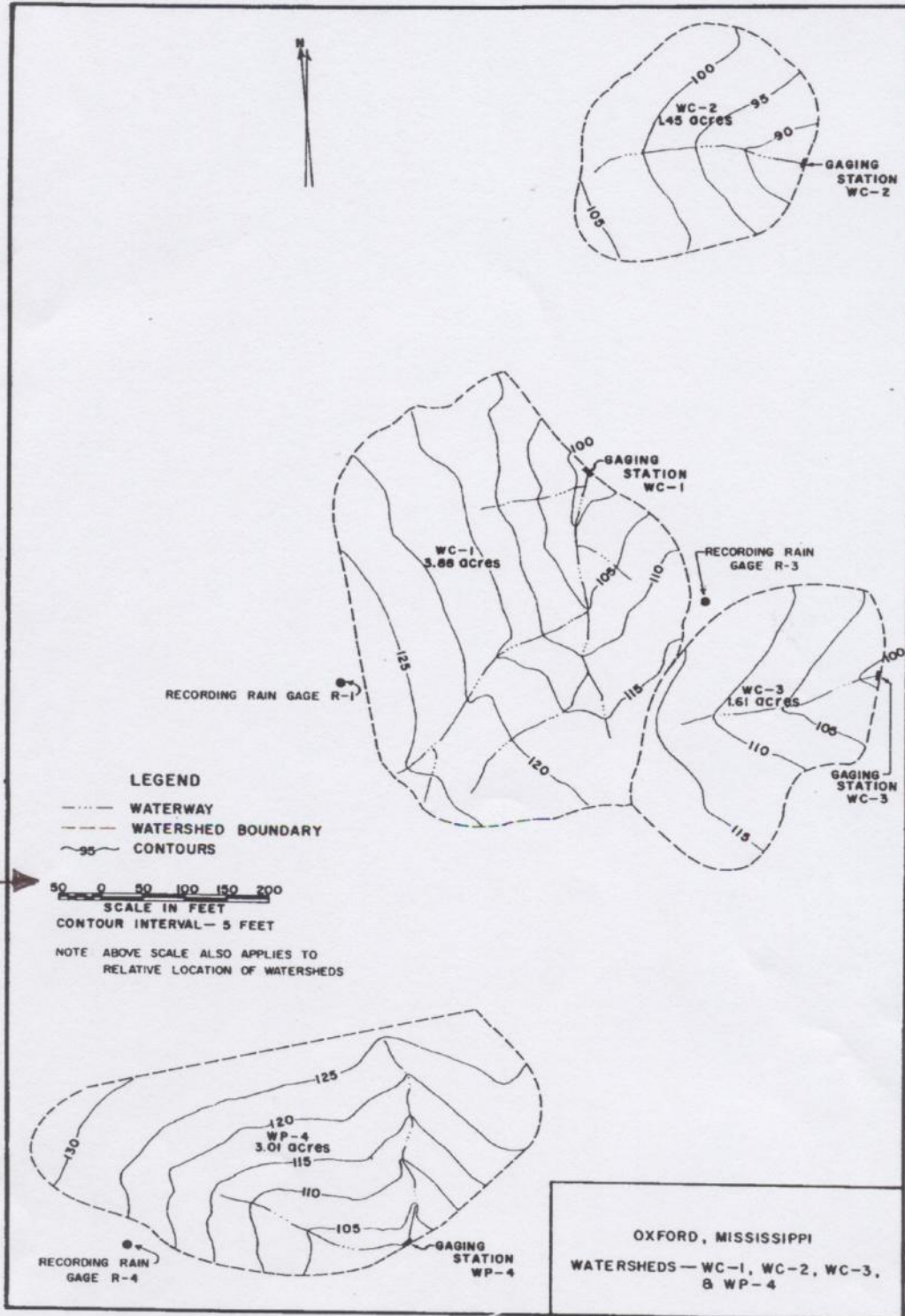

NOTE: IF NO SCALE, DO NOT PROCEED - UNLESS
MAP IS AN ORIGINAL, RESULTS WILL BE
DISTORTED

PATH LENGTHS & SLOPES

PAGE 2

② DRAW PATH

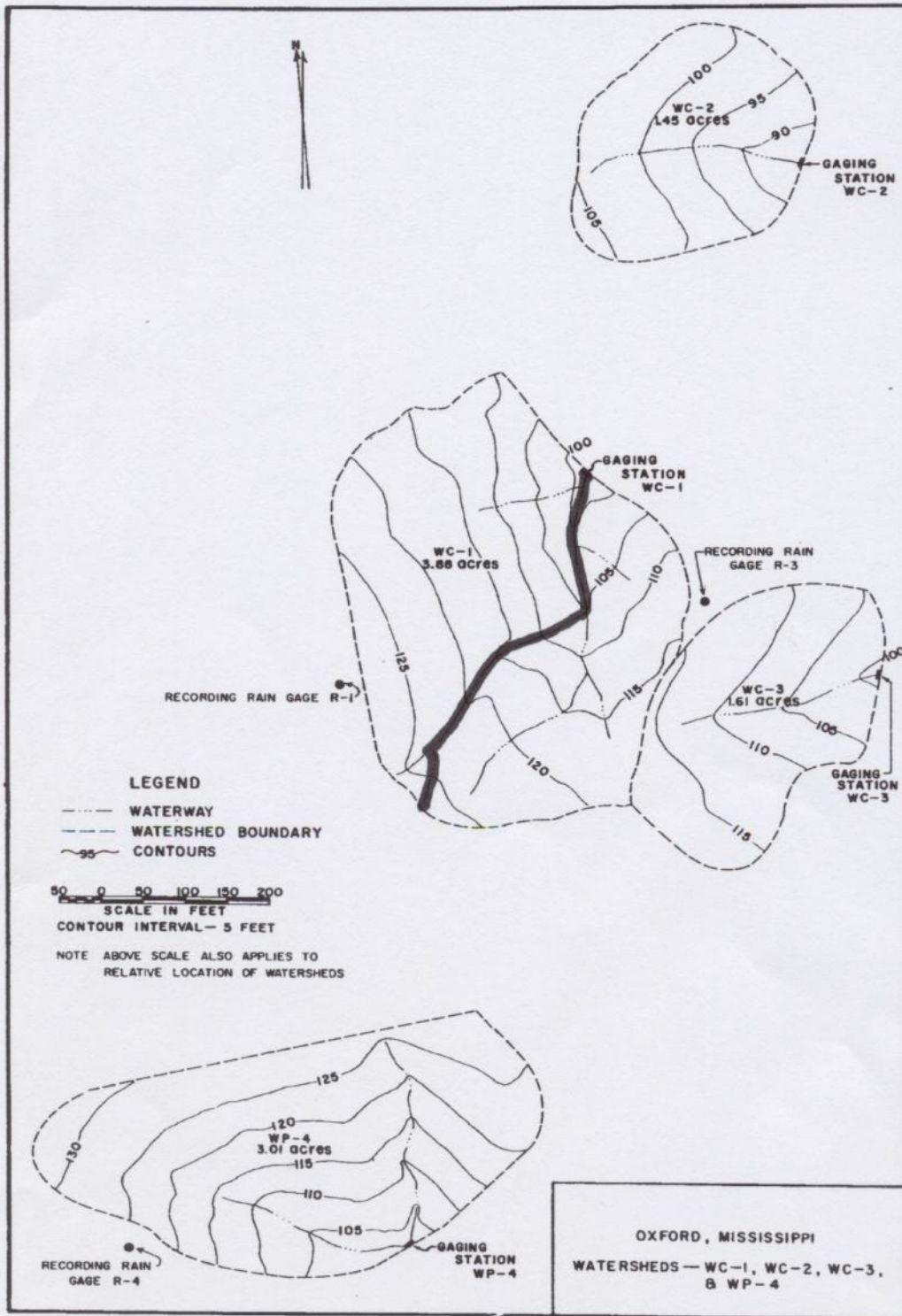

③ USE EDGE OF PAPER TO FOLLOW PATH, MARK EDGE & TURNING POINTS ON MAP

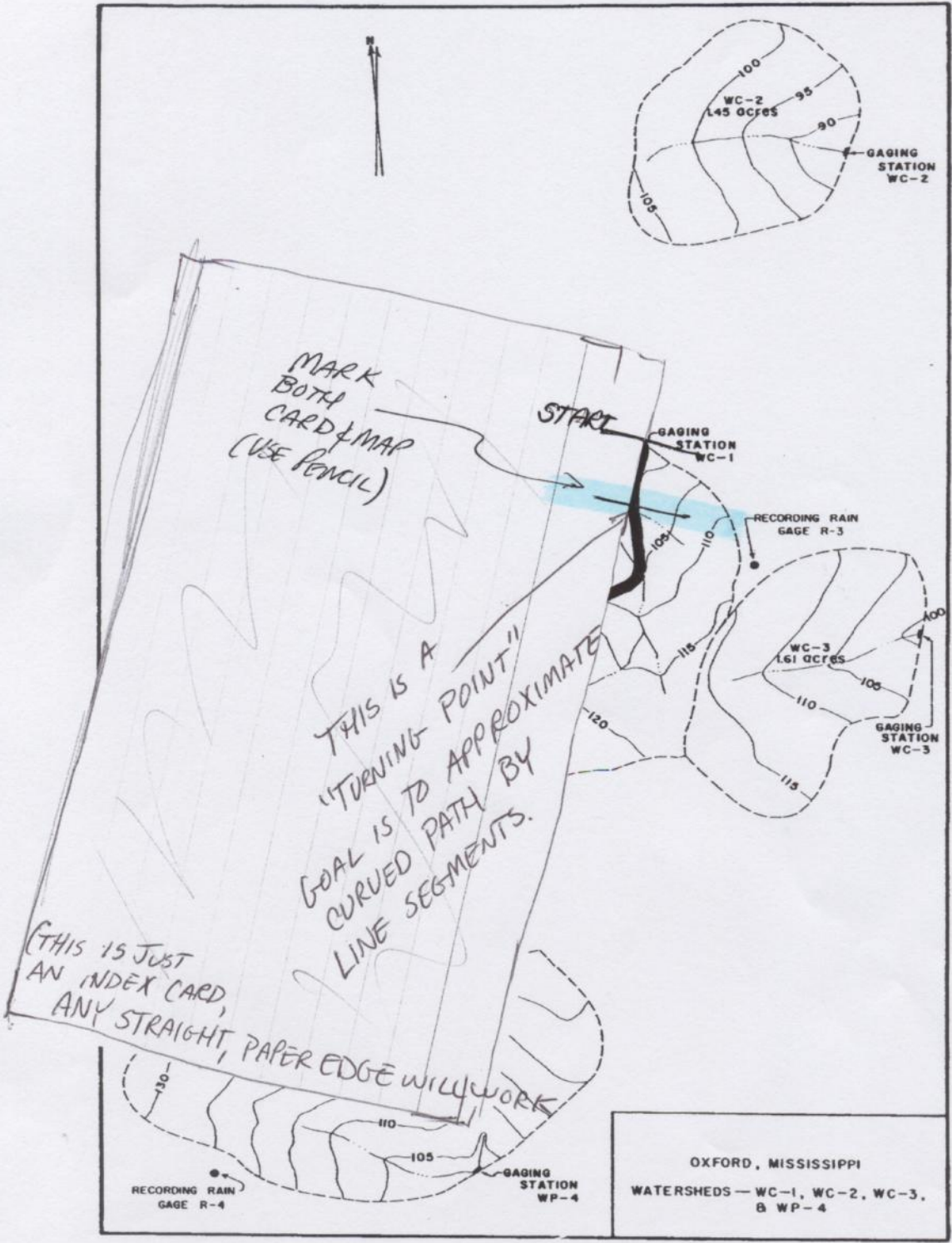

③ USE EDGE OF PAPER TO FOLLOW PATH, MARK EDGE & TURNING POINTS ON MAP

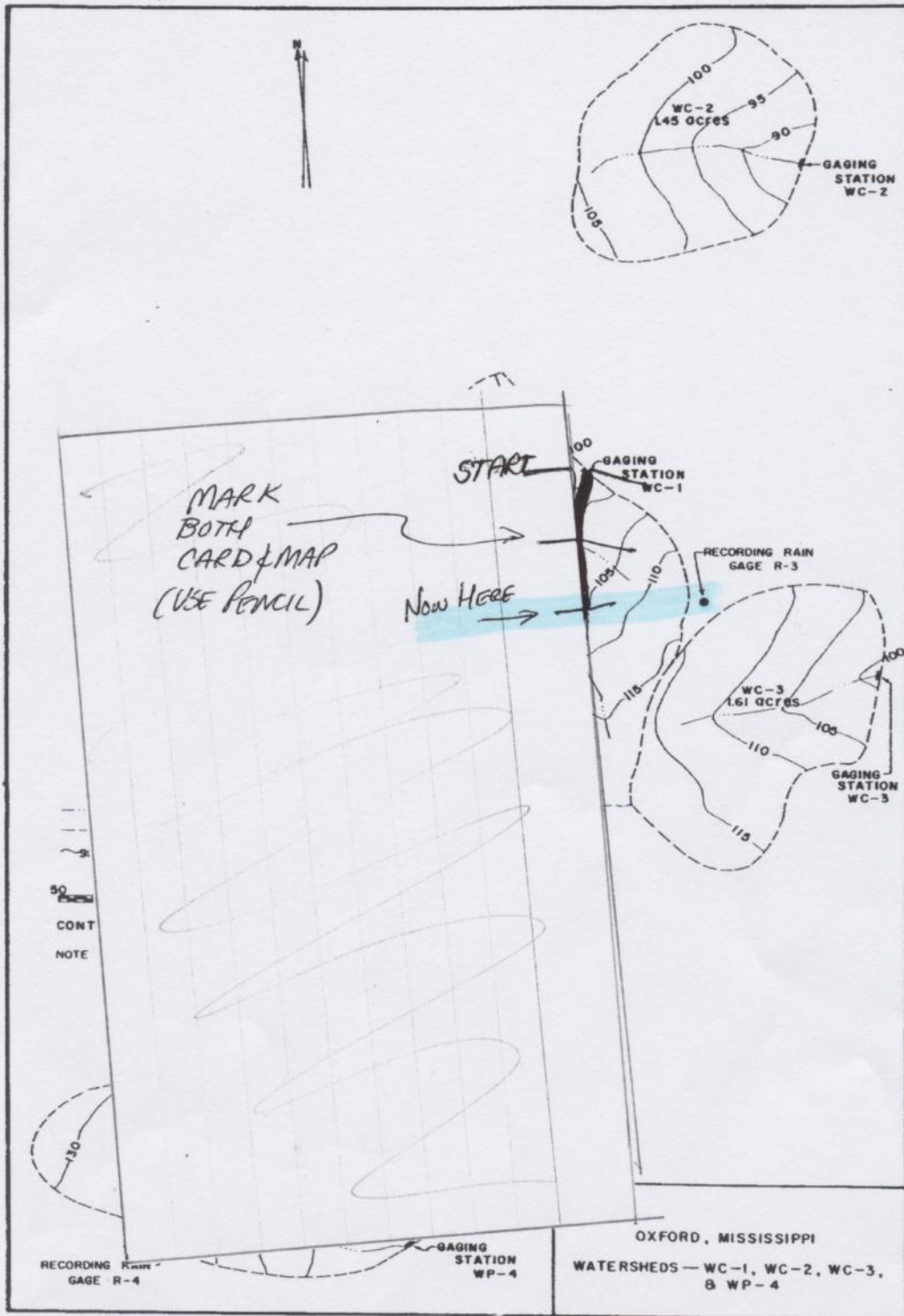

③ USE EDGE OF PAPER TO FOLLOW PATH, MARK EDGE & TURNING POINTS ON MAP

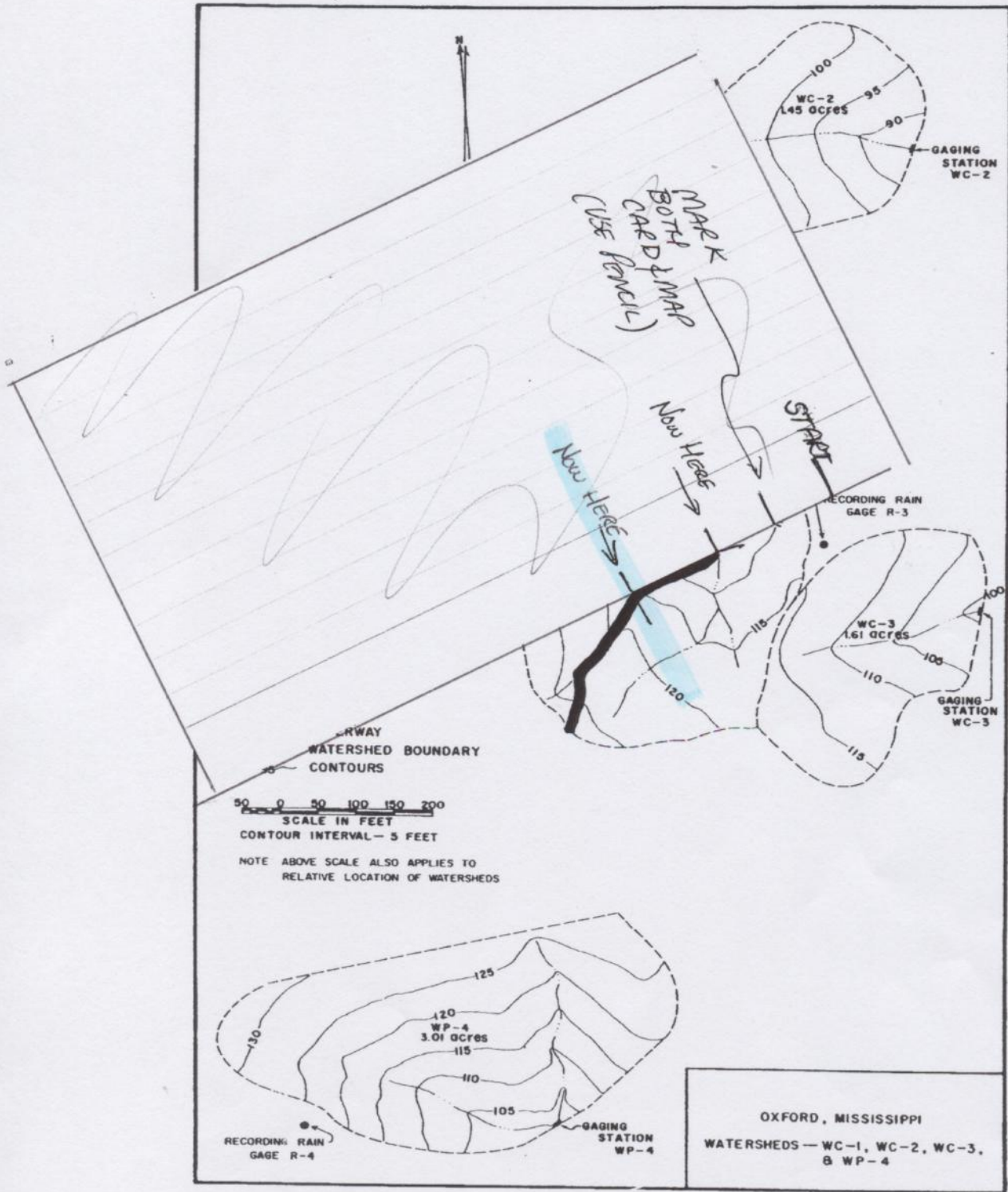

③ USE EDGE OF PAPER TO FOLLOW PATH, MARK EDGE & TURNING POINTS ON MAP

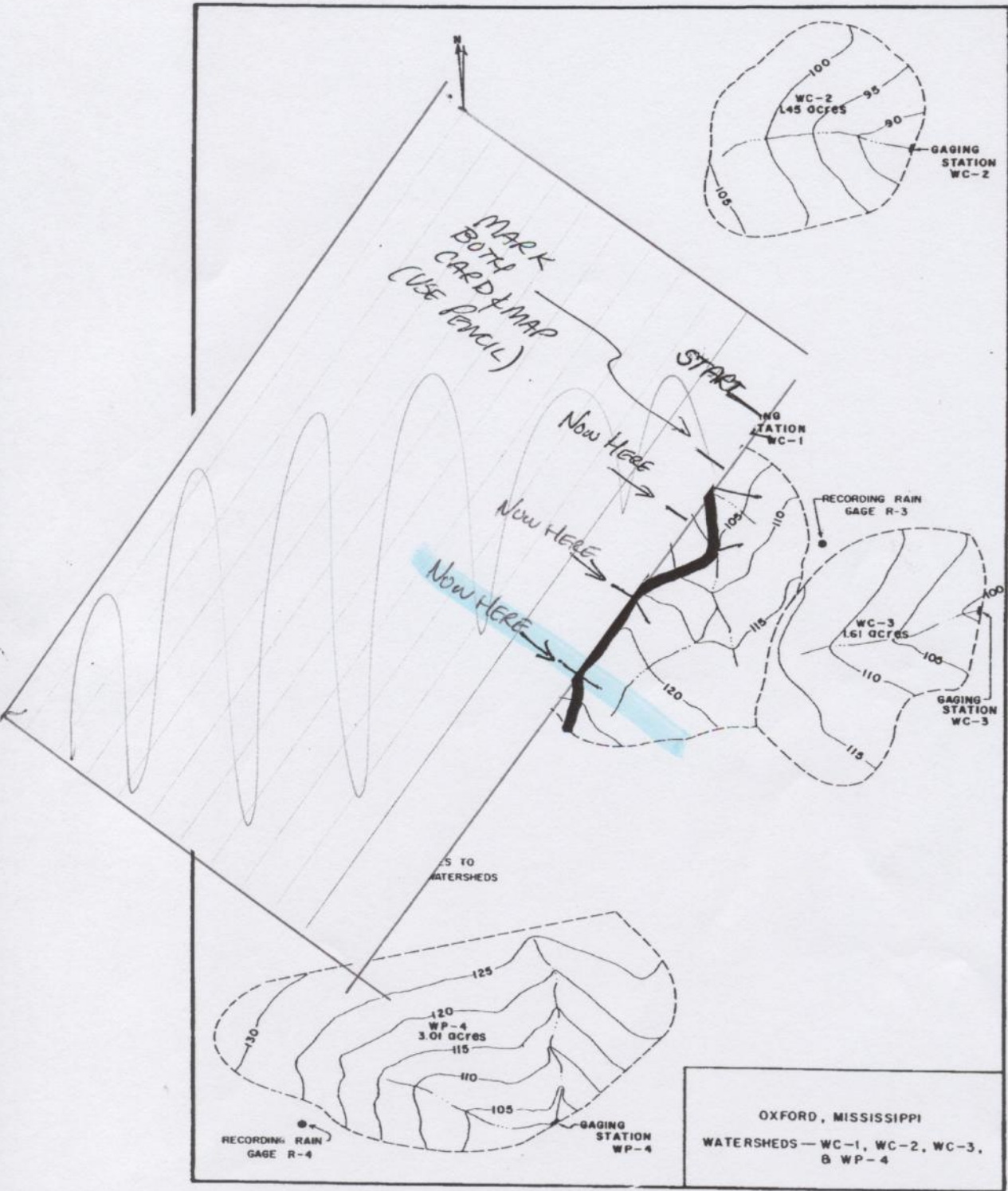

③ USE EDGE OF PAPER TO FOLLOW PATH, MARK EDGE & TURNING POINTS ON MAP

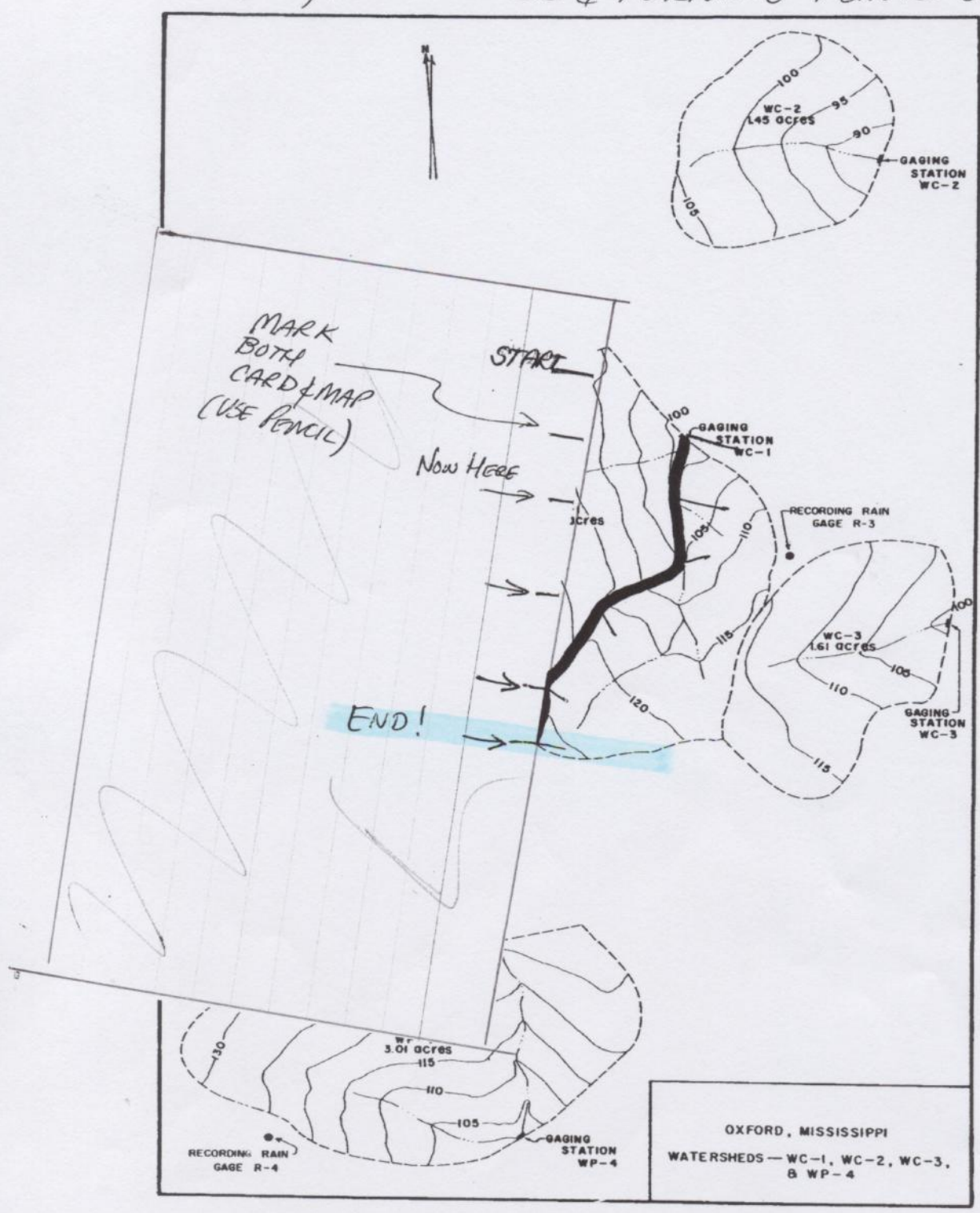

④ Now USE CARD MARKS & MAP SCALE TO FIND PATH LENGTH

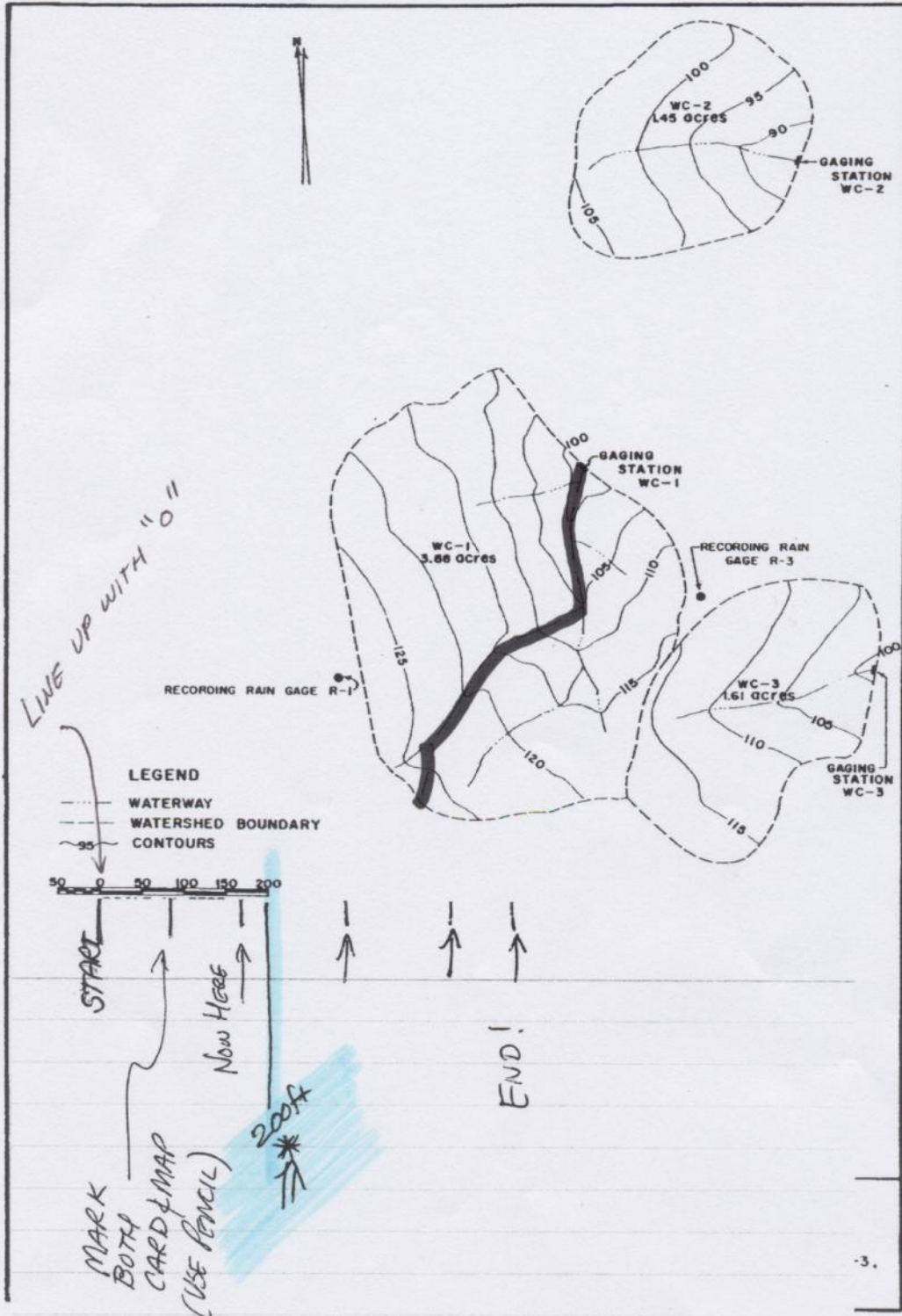

④ Now USE CARD MARKS & MAP SCALE TO FIND PATH LENGTH

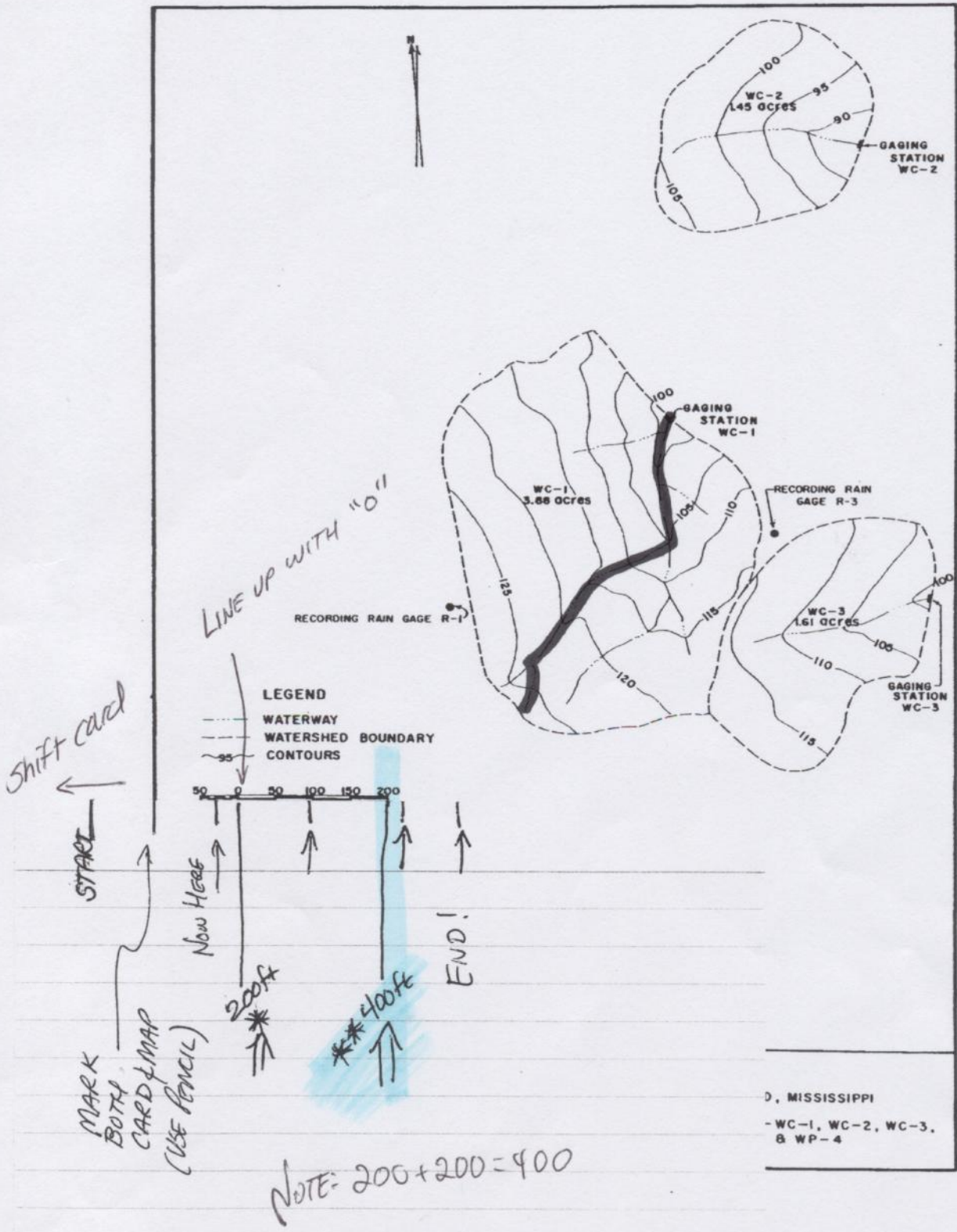

④ Now USE CARD MARKS & MAP SCALE TO FIND PATH LENGTH

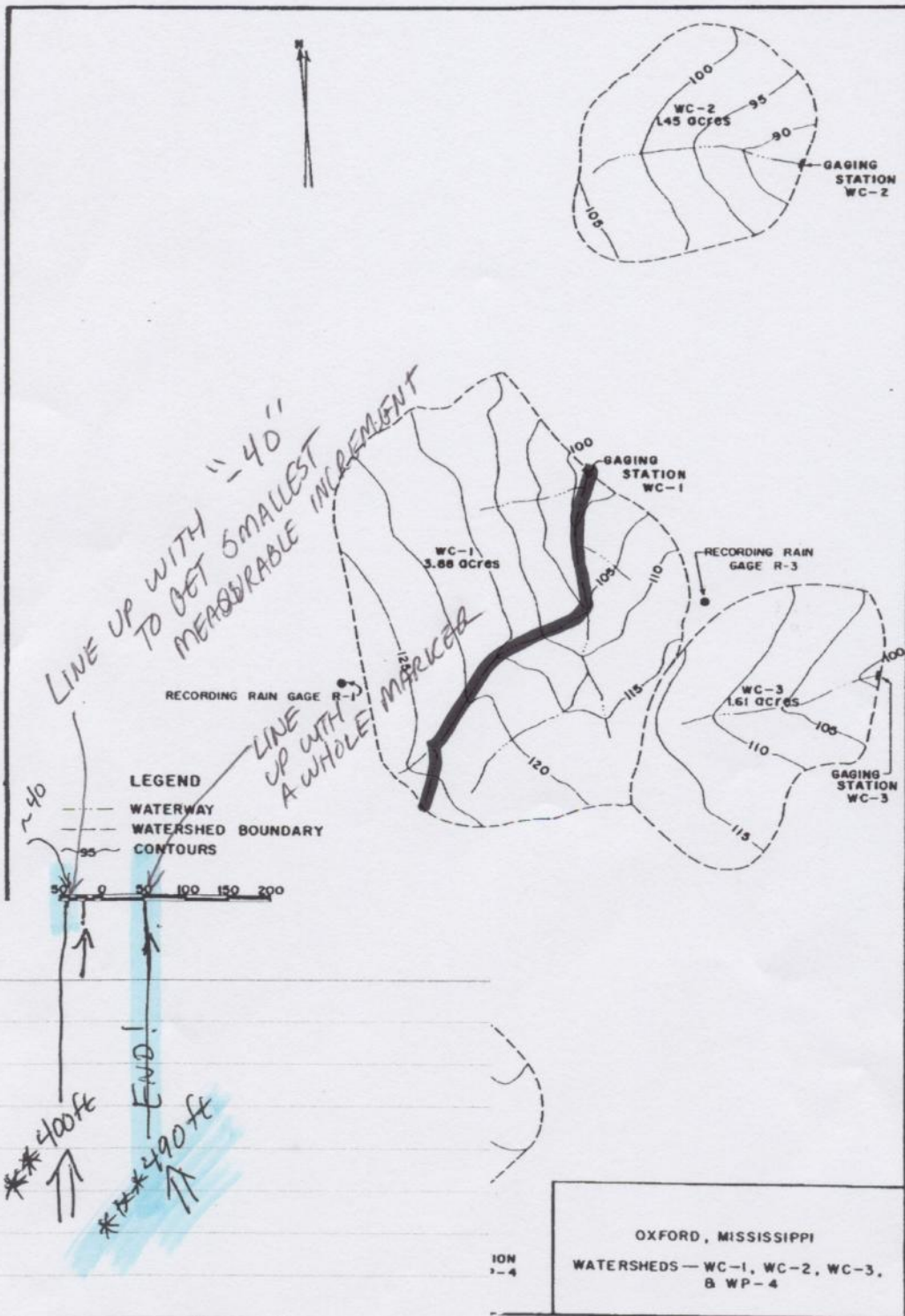

CARD & MAP (USE PENCIL)
Now Here
200ft
400ft
490ft
END!

NOTE: $200 + 200 + 90 = 490$
 $\circ\circ$ PATH \approx 490 feet

⑤ ESTIMATE ΔZ (ELEVATION ALONG PATH),
 REPORT RESULTS

PAGE 11

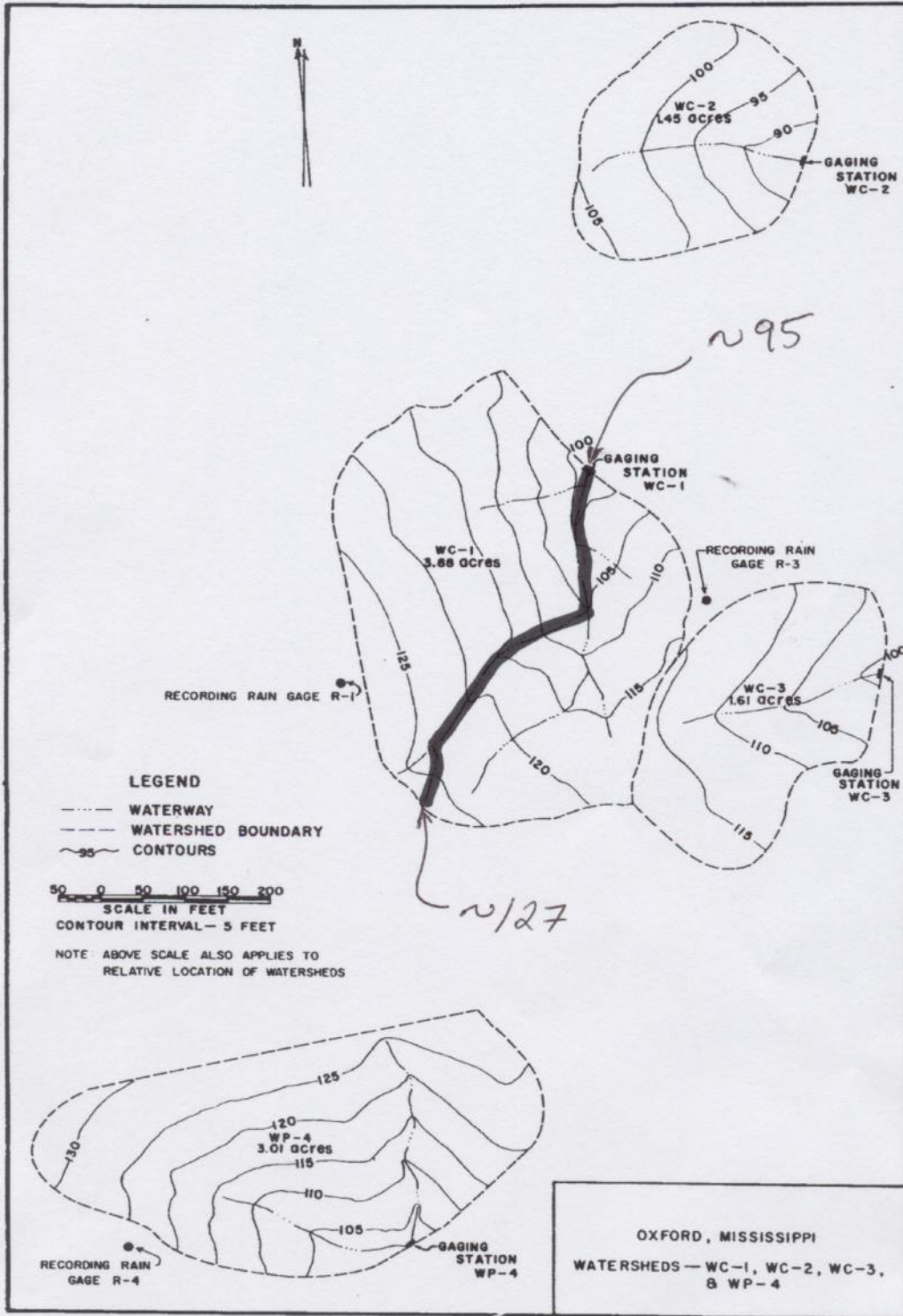

$$\Delta Z = 127 - 95 = 32 \text{ ft}$$

$$MCL = 490 \text{ ft}$$

$$MCS = \frac{\Delta Z}{MCL} = 0.065$$